



THE  
**ACOUSTICS**  
COMPANY

# MONTAGE

Acoustic Panels





## PRODUCT INFO

Montage is the perfect solution for reducing reverberation and echo, offering exceptional sound control with a stylish finish. Available in 30mm, 50mm, and 70mm thicknesses, these panels are crafted from premium BASOTECT® melamine foam, renowned for its lightweight and high-performance acoustic properties.

Each panel is finished with top-quality fabric, available in over 500 colours and textures, ensuring seamless integration with any interior design. Custom-made for a precise fit, Montage panels feature a self-adhesive peel-and-stick backing for effortless installation. With a variety of shapes, sizes, and thicknesses, Montage provides a tailored solution to meet your unique acoustic needs while elevating the aesthetics of your space.

# MONTAGE DESIGNS

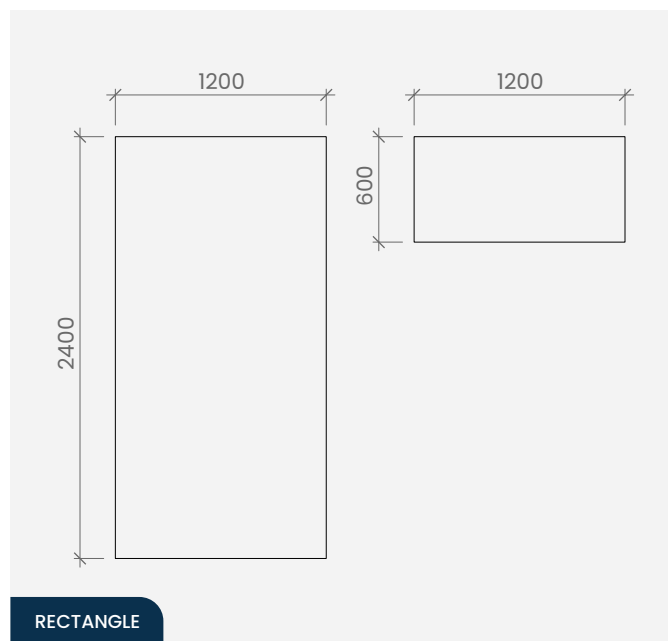
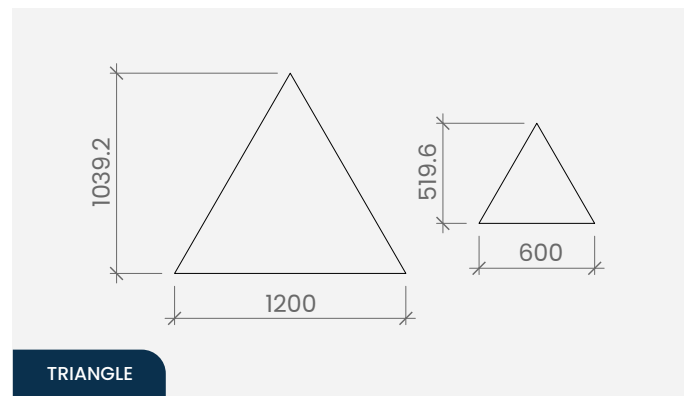
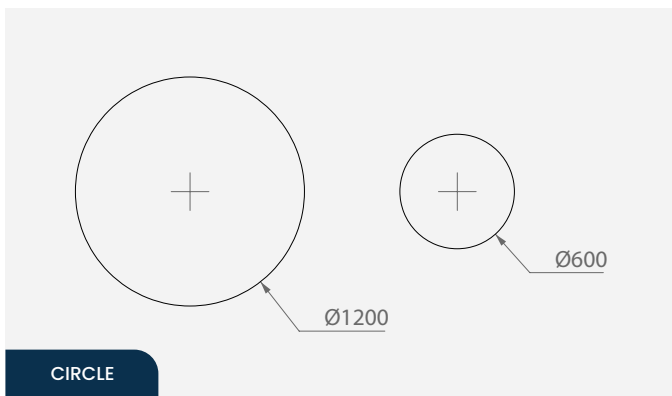
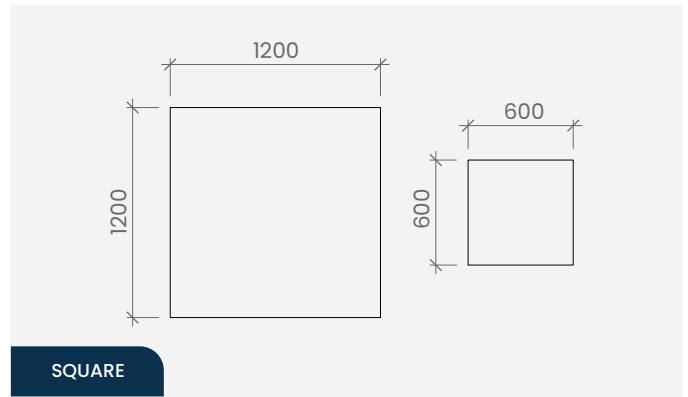
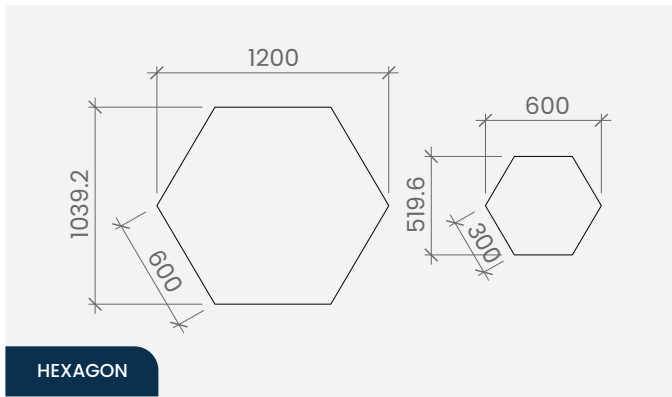

PRODUCT	ARTICLE	DIMENSION	THICKNESS
Circle	04WTMON-CIR000	Dimensions shown above	30/50/70mm
Hexagon	04WTMON-HEX000	Dimensions shown above	30/50/70mm
Square	04WTMON-SQU000	Dimensions shown above	30/50/70mm
Triangle	04WTMON-TRI000	Dimensions shown above	30/50/70mm
Rectangle	04WTMON-REC000	Dimensions shown above	30/50/70mm

# MATERIAL INFORMATION

<b>COMPOSITION:</b>	Basotech Foam/Fabric Faced
<b>FIRE RATING CORE:</b>	BS 478: PART 6: 1989+A1:2009 (17.4)
<b>FABRIC: FIRE RATING – On Request</b>	BS 478: PART 7: 1997 Class 1, Class 0 Core
<b>DENSITY:</b>	9kg/m <sup>3</sup>
<b>ACOUSTICS:</b>	Class A and D Absorbers

\*Our Echo panels have a Thickness Tolerance of  $\pm 4$  mm and a Length & Width Tolerance of  $\pm 6$  mm

\*Fire rating of the fabric is available upon request.



## FINISHES

Montage is finished in industry leading fabrics. The selection has different textures and colours that would compliment any interior space and concept. Please refer to the QR codes below:



### Finishes

Scan the code or visit [www.acousticscompany.com/finishes](http://www.acousticscompany.com/finishes)



### Catalogue

Scan the code or visit <https://acousticpanels.co.uk/wp-content/uploads/2025/09/PRODUCT-BROCHURE-2025.pdf>

## INSTALLATION

The Acoustics Company cater for all project budgets and have multiple fixing methods. Montage acoustic panels can be installed using the following method:

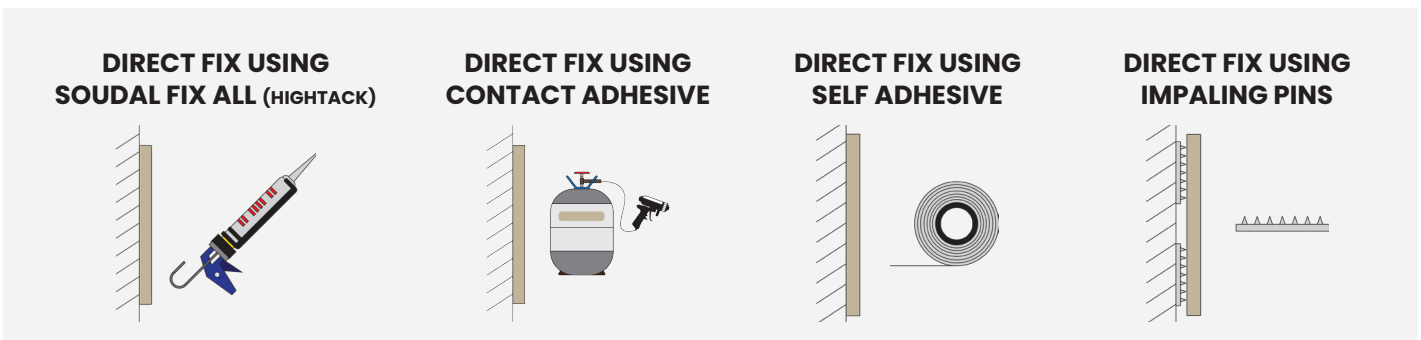

## DESIGN TIPS

**These are just some design tips you can do in order to maximise the full potential of our Montage products:**

1. Choose a fabric that complements the overall aesthetic of the space. Consider factors such as colour, texture, and pattern.
2. Opt for durable fabrics that are easy to clean, as they will be exposed to wear and tear over time.
3. Create beautiful patterns by playing around with the shapes and their layout as well as fabric colour combination.

# ACOUSTIC PERFORMANCE

The acoustic performance of materials refers to their ability to absorb, reflect, or transmit sound waves. This concept is crucial in architecture, interior design, and engineering, as it determines how sound behaves in a space. Materials with good acoustic performance can reduce noise levels, improve speech intelligibility, and create more comfortable and functional environments by controlling reverberation and sound transmission.

## TESTING STANDARDS

<b>ISO 354</b>	Measurement of sound absorption in a reverberation room
<b>ISO 11654</b>	Sound absorbers for use in buildings – Rating of sound absorption
<b>ASTM C423-17</b>	Standard Test Method for Sound Absorption and Sound Absorption Coefficients by the Reverberation Room Method
<b>ACOUSTICS:</b>	Sound absorbers for use in buildings – Rating of sound absorption

<b>ACOUSTICALLY TESTED ECHO PANELS</b>	<b>aw</b>	<b>NRC</b>	<b>CLASS</b>
Echo 30mm Direct Fix	0.45(H)	0.55	D
Echo 50mm Direct Fix	0.90	0.85	A
Echo 70mm Direct Fix	1.00	0.95	A

For aw, it is strongly recommended to use this single-number rating in combination with the complete sound absorption curve that can be obtained on request.

<b>FREQUENCY (Hz)</b>	<b>125</b>	<b>250</b>	<b>500</b>	<b>1000</b>	<b>2000</b>	<b>4000</b>
Echo 30mm Direct Fix	0.10	0.20	0.45	0.65	0.80	0.85
Echo 50mm Direct Fix	0.25	0.60	0.90	0.95	1.00	0.95
Echo 70mm Direct Fix	0.35	0.85	1.00	0.95	0.95	1.00

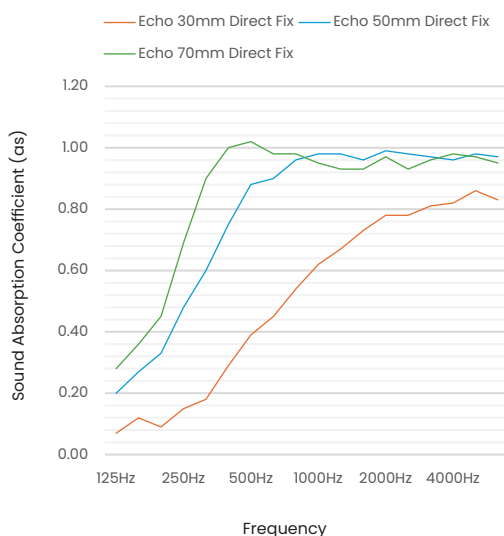

Weighted Sound Absorption Coefficient (aw) – Measured in accordance with ISO 11654. Practical sound absorption coefficient ap values at given standard frequencies are compared with reference curve aw.

Noise Reduction Coefficient (NRC) – The mean average as value at frequencies 250, 500, 1000 and 2000 Hz.

Absorption Class – Levels of comparison of absorption values against a reference curve with A as highest and E as lowest. Measured in accordance with ISO 11654.

Practical Sound Absorption Coefficient (ap) – The average of the three as values centered on the 1/3 octave band center frequency, measured in accordance with EN ISO 354.

Note: The sound absorption values provided in this product sheet are subject to change without prior notice from The Acoustics Company. For the most current and accurate technical specifications, please contact our Sales Team directly.

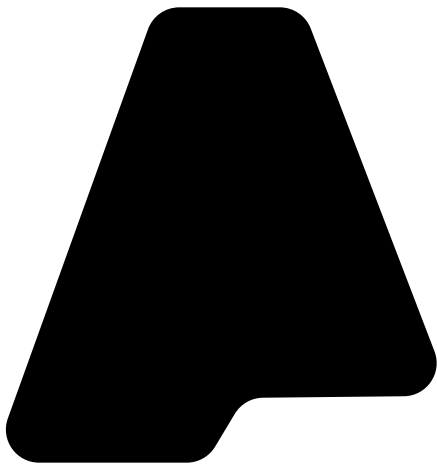

# THE ACOUSTICS COMPANY



[www.acousticscompany.com](http://www.acousticscompany.com)    @theacousticscompany

#ResonateBliss